

## Mola Stories

Yardage Requirements based on 44" wide

First Main Print	2/3 yard
Second Main Print	2/3 yard
Black Multi	1/4 yard
Red Accent	3/8 yard
White Accent	3/8 yard
White Background	3/8 yard
Black Background	1/4 yard
Turquoise	1/4 yard
Yellow	1/4 yard
Red	1/4 yard
1st Border	1/2 yard
Border Print	1 1/3 yards or 2 1/8 yards if directional
Binding	1/2 yard
Backing	4 1/2 yards

### Supplies needed:

*Basic sewing supplies; sewing machine; rotary cutter; mat and ruler.*

VISIT OUR WEBSITE FOR THE LARGEST SELECTION OF SW and WESTERN FABRICS, PATTERNS, BLOCK OF THE MONTH PROJECTS, ACCESSORIES, NOTIONS & MUCH MORE!!

[www.swdecoratives.com](http://www.swdecoratives.com)



Designed by Betty Ann Standiferd  
© 2005-2009 SOUTHWEST DECORATIVES  
5711 Carmel Ave NE, Ste. B  
ALBUQUERQUE, NM 87113  
(505) 821-7400  
info@swdecoratives.com

### **THIS PATTERN IS NOT SHAREWARE!**

All rights reserved. No part of this pattern may be photocopied or reproduced without written consent of Southwest Decoratives. All finished items produced from this pattern are protected by federal copyright laws and may not be reproduced for commercial use in any form without written consent from Southwest Decoratives.

# Mola Stories

Complimentary



This easy All Pieced Pattern makes a  
51 1/2" x 75 1/2" Finished Quilt  
Designed by Betty Ann Standiferd

**CUTTING DIRECTIONS**

All strips are cut from salvage to salvage, across the width of the fabric (wof).

From First Main Print (Black Molas) cut:

- 7 mola figures  $6\frac{1}{2}$ " x  $6\frac{1}{2}$ "
- From Second Main Print (White Molas) cut:
  - 8 mola figures  $6\frac{1}{2}$ " x  $6\frac{1}{2}$ "
- From Black Multi cut:
  - 2 strips  $3\frac{7}{8}$ " x wof, subcut into Sixteen  $3\frac{7}{8}$ " squares
- From Red Accent cut:
  - 5 strips  $2$ " x wof, subcut into Thirty Two  $2$ " x  $6\frac{1}{2}$ " strips
  - From White Accent cut:
    - 5 strips  $2$ " x wof, subcut into Twenty Eight  $2$ " x  $6\frac{1}{2}$ " strips.

From White Background cut:

- 3 strips  $3\frac{7}{8}$ " x wof, subcut into Thirty  $3\frac{7}{8}$ " squares.
- From Black Background cut:
  - 2 strips  $3\frac{7}{8}$ " x wof, subcut into Fourteen  $3\frac{7}{8}$ " squares.
- From Turquoise cut:
  - 4 strips  $2$ " x wof, subcut into Sixteen  $2$ " x  $6\frac{1}{2}$ " strips.
- From Yellow cut:
  - 4 strips  $2$ " x wof, subcut into Twenty  $2$ " x  $6\frac{1}{2}$ " strips.
- From Red cut:
  - 4 strips  $2$ " x wof, subcut into Twenty four  $2$ " x  $6\frac{1}{2}$ " strips.

From Black cut:

- 13 strips  $2\frac{1}{2}$ " x wof for 1st border and binding.
- From Border Print cut:
  - 7 strips,  $6$ " x wof, OR, 4 strips  $6$ " x length if using directional fabric. Subcut 2 strips  $6$ " x  $77$ " and the remaining 2 strips  $6$ " x  $54$ "

**PIECING DIRECTIONS**

Sew B Units:

1. Create B units by pairing up the  $2$ " x  $6\frac{1}{2}$ " rectangles according to the following:
  - 16 Yellow to 16 Red Accent
  - 24 Red to 24 White Accent
  - 16 Turquoise to 16 Red Accent
  - 4 Yellow to 4 White Accent

2. Sew together and press seam allowance to one side. Set aside.

Sew C Units:

3. These are  $1/2$  square triangles. Pair up all 30 Of the White Accent  $3\frac{7}{8}$ " squares with 14 Black Background, and 16 of the Black Multi. Pair two  $3\frac{7}{8}$ " squares right sides together, lightly mark along the diagonal, on lighter fabric with a pencil  $1/4$ " away from center on both sides.

4. Sew on drawn lines. Cut down the center to separate into triangles. Open into squares. Press seams to one side. Each pairing of squares will make two  $1/2$  square triangles.

Block Assembly:

5. Refer to Fig. 3 for placement of A ( $6\frac{1}{2}$ " Main Print Fabrics/Mola Squares) B and C units. Lay out each block (refer to pattern cover) Sew the blocks together working across in rows. Sew a C unit onto each end of two B units. Sew a B unit on two opposite sides of Unit A ( $6\frac{1}{2}$ " square of Main Print). See Figure 1 for layout. Press seams in opposite directions.
5. Sew rows together to yield finished block (Figure 2). Press.

7. Arrange blocks referring to pattern cover. Sew together 3 blocks for each row. Press seam allowances in opposite directions. Sew rows together and press.

8. Sew inner border strips into a continuous length. Measure the width of the quilt. Cut inner border to that length and add to the top and bottom of the quilt. Then do the same with the sides.

9. Measure quilt vertically (top to bottom). Sew two sets of  $6$ " x wof to form  $80$ " long strips. Subcut to vertical measurement. With right sides together, pin and sew one strip on each side of quilt. Next measure quilt horizontally (side to side). Sew remaining three strips of border fabric to make one long strip  $120$ " long. Subcut two sets of strips to the horizontal measurement, pin and sew to top and bottom. ~ OR ~ if using directional fabric...

10. Find the center point along each side of the quilt top and along the length of each outer border strip. With right sides together, pin each border to quilt top matching the centers and allowing excess fabric to extend beyond the ends for mitering. Individually attach each of the four borders, leaving corners free. Start and stop stitching  $1/4$ " from corner. Press seams toward border. Miter each corner. Press Again.

11. Layer the quilt top with batting and backing. Quilt as desired. Bind the edges. When placing the binding on, sew a stitch  $1/4$ " away from the border stripe so there is a guide line to place binding.

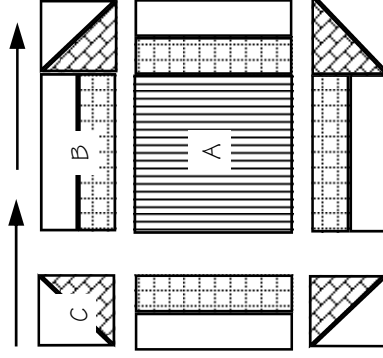

Figure 1

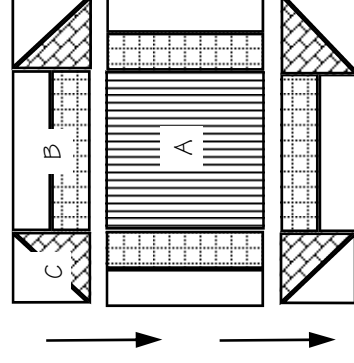

Figure 2

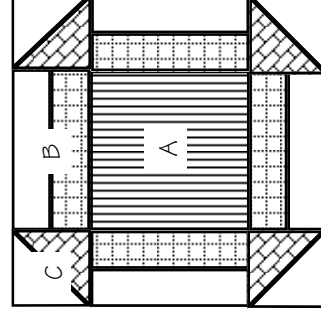

Figure 3